

ATTENUATOR CHIP 0.2 WATT



DATA SHEET

PART SERIES: TS09XXSMT

SHEET 1 OF 2
Dwg 1012955

EN 16-0703
Revision B

FEATURES

- Small Footprint
- High Power
- Surface Mount
- Low VSWR
- Easy Installation
- Wide Attenuation Offering

APPLICATIONS

- Mobile Networks
- Broadcast
- High Power Amplifiers
- Isolators/Circulators
- Military
- Instrumentation



GENERAL DESCRIPTION

EMC Technology offers the widest selection of chip attenuators worldwide. Chip components are offered in Alumina, Aluminum Nitride, Beryllium Oxide, and CVD diamond for maximum performance.

ORDERING INFORMATION

Part Identifier: TS09XXSMT
(XX) – dB Value

SPECIFICATIONS

1.0 ELECTRICAL

Nominal Impedance: 50 ohms
Frequency Range: DC – 20 GHz
Attenuation Values Available: 1 – 10 in 1 dB increments
Attenuation Accuracy:

ATTENUATION ACCURACY @25°C		
dB	DC – 15 GHz	15-20 GHz
0 – 4	±0.5	±0.5
5 – 10	±0.5	±0.75

Input Power CW: 200 Milliwatts full rated power to 125°C, derated linearly to 0 watts at 150°C.
VSWR @ 25°C: DC – 20 GHz - 1.40:1 Typical
DC – 20 GHz - 1.70:1 Max

2.0 ENVIRONMENTAL

Operating Temperature: -55°C to +150°C

3.0 MARKING

Unit Marking: None

4.0 QUALITY ASSURANCE

Sample Inspect Per MIL-STD-105, Level II, 1.0% AQL

- Visual and Mechanical Inspection for Conformance to Outline Drawing
- Measure Attenuation and VSWR
- Data Retention - Standard

5.0 PACKAGING

Standard Packaging: Tape and Reel

ATTENUATOR CHIP 0.2 WATT

6.0 MECHANICAL

Resistive Film:	Thick Film
Terminal Material:	Thick Film, Nickel Barrier, Solder Plated
Metric Dimensions:	Provided for reference only
Workmanship	PER MIL-R-55342

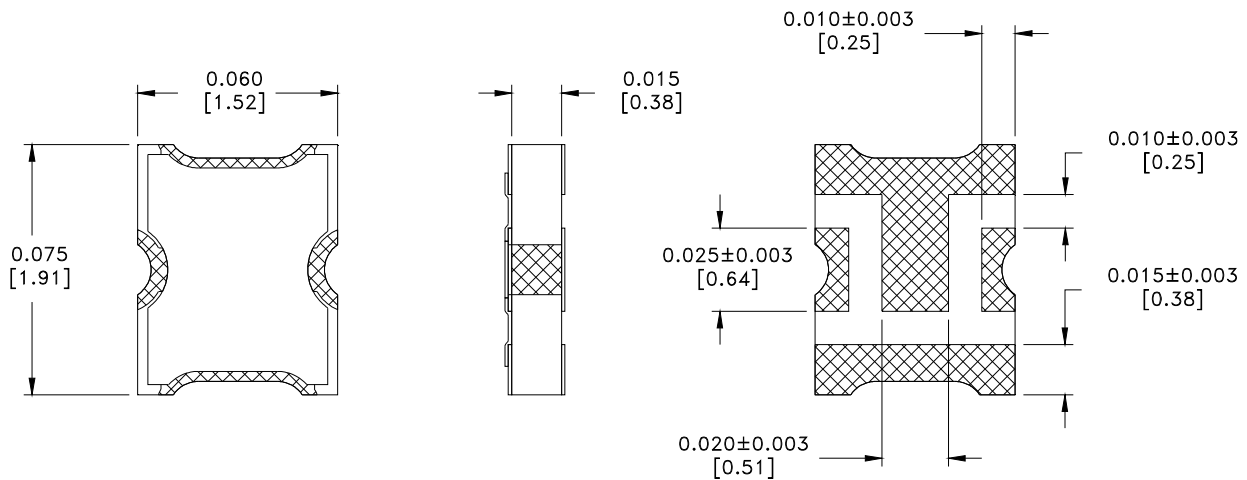

Unless Otherwise Specified: TOLERANCE: X.XXX = ± 0.005

7.0 SUGGESTED MOUNTING FOOTPRINT

Part Number	Inches						mm					
	A	B	C	D	S	W	A	B	C	D	S	W
TS09XXSMT	0.019	0.011	0.012	0.041	0.012	0.070	0.48	0.28	0.30	1.04	0.30	1.78

