

**TITLE: SPECIFICATION CONTROL DRAWING**  
**EMC PROPRIETARY**

<b>REVISIONS RECORD</b>			
<b>REV</b>	<b>SHEET</b>	<b>DATE</b>	<b>DESCRIPTION</b>
-	1-2	4/22/04	EN 04-E095, INITIAL RELEASE
-	1	10/8/04	EN 04-231, REMOVE SIGNATURE BLOCK, NO REV CHANGE
A	1-2	05/15/07	EN 07-E0486, UPDATE SCD FOR POWER RATING
B	1-2	5/27/08	EN 08-E0399, REMOVE IP AND MC DOCS AND REPLACE WITH NEW ISO DOCS

<b>EMC TECHNOLOGY</b> 8851 SW OLD KANSAS AVE. STUART, FL 34997	<b>CAGE CODE # 24602</b>	<b>DWG# 1010145000</b>	<b>SHEET</b>	<b>REF</b>
			<b>REV LEVEL</b>	<b>B</b>

**TITLE: SPECIFICATION CONTROL DRAWING**

**PART IDENTIFIER:** CT1206ALNF

**DESCRIPTION:** CHIP TERMINATION, ALUMINUM NITRIDE LEAD FREE PLATING

**ASSEMBLY DWG:** 1101664

**1.0 SPECIFICATIONS:**

- 1.1 ELECTRICAL:
  - 1.1.1 IMPEDANCE: 50Ω NOMINAL.
  - 1.1.2 FREQUENCY: DC - 4 GHZ.
  - 1.1.3 VSWR: 1.25:1 MAX.
  - 1.1.4 INPUT POWER:
    - 1.1.4.1 HEAT SINK 100°C: 15 WATTS. (DERATE POWER LINEARLY TO 0 WATTS @ 125°C)
- 1.2 MECHANICAL:
  - 1.2.1 OUTLINE DWG: SEE SHEET 2.
- 1.3 ENVIRONMENTAL:
  - 1.3.1 TEMPERATURE RANGE:
    - 1.3.1.1 NON-OPERATING: -55°C TO +150°C.
    - 1.3.1.2 OPERATING: -55°C TO +125°C.

**2.0 UNIT MARKING:** NONE.

**3.0 QUALITY ASSURANCE:**

- 3.1 SAMPLE INSPECT PER ANSI/ASQC Z1.4 GENERAL INSPECTION, LEVEL II, AQL = 1.0.
  - 3.1.1 VISUAL AND MECHANICAL PER 824W154.
- 3.2 DC RESISTANCE: 50Ω ± 5%.
- 3.3 DATA REQUIREMENTS:
  - 3.3.1 NO TEST DATA REQUIRED FOR CUSTOMER.
  - 3.3.2 DATA RETENTION - STANDARD.

**4.0 PACKAGING:** STANDARD BULK PACK PER 755W002.

<b>EMC TECHNOLOGY</b> 8851 SW OLD KANSAS AVE. STUART, FL 34997	<b>CAGE CODE # 24602</b>		<b>DWG #</b>	1010145000
	<b>CHANGE NOTICE</b>	EN 08-E0399	<b>REV LVL</b>	B
			<b>SHEET</b>	1 OF 2

PART ID REF  
CT1206ALNF

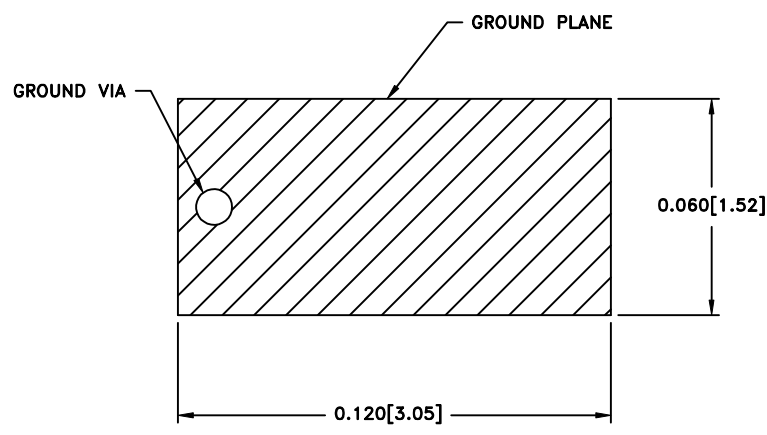
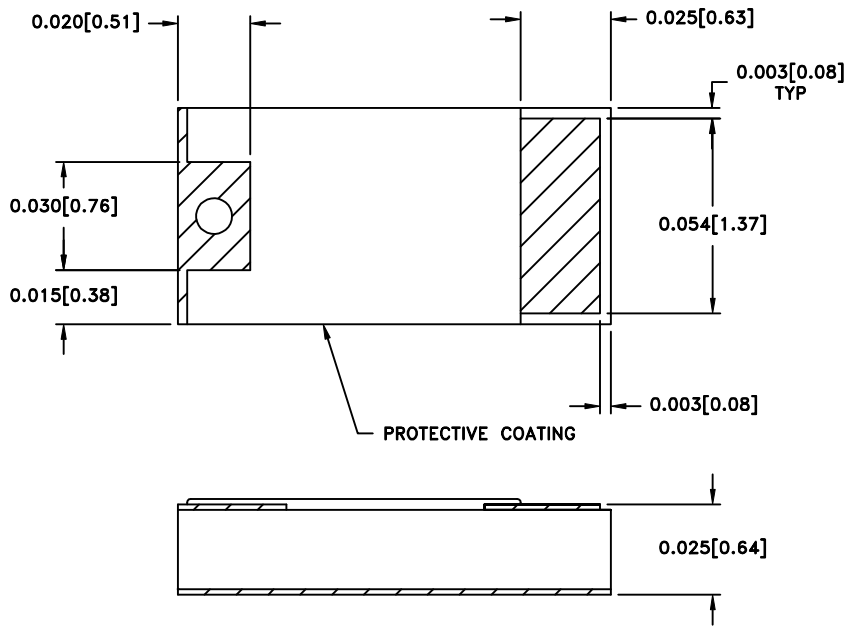

**MECHANICAL SPECIFICATION:**

SUBSTRATE:  
MATERIAL - ALUMINUM NITRIDE, MIL-I-10.  
TERMINALS & GROUND PLANE:  
MATERIAL - THICK FILM

METRIC EQUIVALENTS GIVEN IN [mm]  
FOR REFERENCE INFORMATION ONLY

RESISTIVE ELEMENT:  
MATERIAL - THICK FILM.

**POWER RATING AND DERATING**

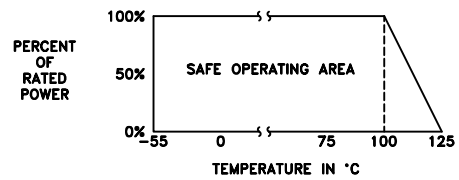

8851 SW OLD KANSAS AVE  
STUART, FL 34997  
PHONE NO. (772)286-9300  
FAX NO. (772)283-5286

UNLESS OTHERWISE SPECIFIED DIMENSIONS ARE IN INCHES  
**TOLERANCES**  
FRACT ---  
ANG ---  
XX ---  
XXX ±0.005  
XXXX ---

THESE DRAWINGS AND SPECIFICATIONS ARE THE PROPERTY OF EMC TECHNOLOGY INC AND SHALL NOT BE DUPLICATED OR USED AS BASIS FOR THE MANUFACTURE OR SALE OF PARTS OR DEVICES WITHOUT PERMISSION.

CAGE CODE 24602	SCALE 30:1	DRAWN BY JG 5/27/08	CHECKED BY	APPROVED BY
REV B	CHANGE NOTICE EN 08-E0399	DRAWING NO 1010145000	SHEET 2 OF 2	